



Contour Recline E-Vertex Servicing



Contour Recline E-Vertex Servicing

Thank you for placing your confidence in our Procedure Chairs. They have been engineered from quality materials and hand-made with care to fulfil the requirements of the healthcare industry. Your chair will give years of trouble-free service if used and cared for in accordance with our directions.

As an Australian manufacturer with the longest warranty, we're committed to delivering the best value in the healthcare industry. If you have a maintenance issue with any of our products, we can help to get you back up and running again very quickly.

All of our parts are usually in stock ready for a 24 hour dispatch. Identify any [Contour Recline E-Vertex Procedure Chair](#) parts that you may need for an emergency repair or future maintenance, and contact us today for a fast, fairly priced response.

To facilitate quick and accurate identification, please supply the **SERIAL NUMBER** found on the **MODSEL** manufacturers label of the product.

Routine inspection of castors and other frame components can usually prevent common problems. After each (12) twelve months of use, the trolley must be checked in accordance with our recommended Service Checklist.

An approved [MODSEL Service Checklist](#) can be downloaded online from [this link](#)

TO ENSURE WARRANTY, PERIODIC MAINTENANCE RECORDS MUST BE RETAINED.

Disposal

- Contact Modsel or your institution expert for advice on disposal of this device.
- DO NOT repurpose this device. Modsel as the legal manufacturer of this medical device can advise if it can be reconditioned.

How To Replace The Lifters

1. Firstly ensure the base cover is free and then lay the chair on its side on the ground. This can be done by the following steps;
2. Stand facing the side of the chair – the side to stand on must be the side that you want to have lain down on the ground.
3. Pull chair towards you until all castors are at 90° to the length of the stretcher (facing away from you) and apply the brakes.
4. With the help of another person, firmly hold either end of the chair and carefully tilt it over until top makes contact with the ground.
5. Remove the bolts that are bolted through the chair top subframe into the top of the lifter.
6. Move the chair top subframe off the top of the lifter.
7. Remove the bolts from the base of the lifter.
8. Replace with new lifter ensuring that the new one is positioned correctly.
9. Using a medium strength thread locker on all bolts, reassemble in the reverse order to the steps above.

How To Adjust The Brake/Steer System

Wear from continuous use may cause the chair brake or steer action to not lock in properly over time. This may need to be corrected by adjusting the length of the Brake Linkage Rod.

1. Lock the brake/steer pedal into the brake position. Check that the castors at the opposite end are locking fully into the brake position at the same time. If not, the Brake Linkage Rod may need to be shortened or lengthened accordingly, to equalise the operation.
2. To adjust the Brake Linkage Rod, lift the plastic base cover.
3. Loosen the rod end lock nut.
4. Remove the rod end retaining bolt and nut and then wind the rod end a half turn in (clockwise) to shorten or out to lengthen the Brake Linkage Rod.
5. Assemble the rod end retaining bolt loosely and test the brake/steer action. Continue to adjust the rod end until the system operates correctly.
6. Re-assemble, locking all bolts and nuts tight.

How To Replace a Castor

1. Check the replacement castor is the correct type (ie. brake or brake/steer, Tente brand).
2. Lift up the plastic base cover and retain.
3. Set the brake pedal the neutral position. Loosen the pedal lock screws at castor to be removed. Using a suitable marker pen, mark the position of the hex lug on the hex rod. Loosen the lock screw on the hex lug to allow the hex rod to slide through. Use a pin punch on the end of the hex rod, to drive clear of the castor.
4. Release the lock tab and remove the castor retaining bolts. Remove old castor. Remove any plastic bolt-hole plugs if in the castor spigot and insert the replacement castor. **DO NOT ROTATE THE CASTOR SPIGGOT, AS THIS MAY ALTER THE CASTOR SETTINGS.**
5. Align the hex rod with the hole in the castor spigot. If the hex rod will not slide through the spigot, remove and rotate entire castor 180° and re-fit. Tap the hex lug back into the original position using a soft hammer and tighten lock screw using medium strength thread locker. Replace the castor retaining bolts together with the existing or new lock tab. Tighten the castor lock screws. Bend bolt locking tabs into position against bolt heads.
6. Replace brake pedal ensuring adequate clearance both sides of the base for the cover.

How To Replace A Headrest Actuator

1. Position the headrest upwards in both its height and tilt functions.
2. Undo the 3 retaining bolts holding the cover on the underside of the headrest.
3. Remove the headrest cover and slide out the plastic strip that covers the underside of the hinge system.
4. Remove the R-Clip and pivot pin retaining the actuator extension at the headrest end.
5. Unwind the actuator extension (anti-clockwise) until the actuator ram becomes free - slide both the extension and ram out.
6. Disconnect the power cable and remove the pin retaining the lower end of the actuator (at the bottom of the backrest)
7. Remove the actuator and replace in the reverse order.

Spare Part Identification

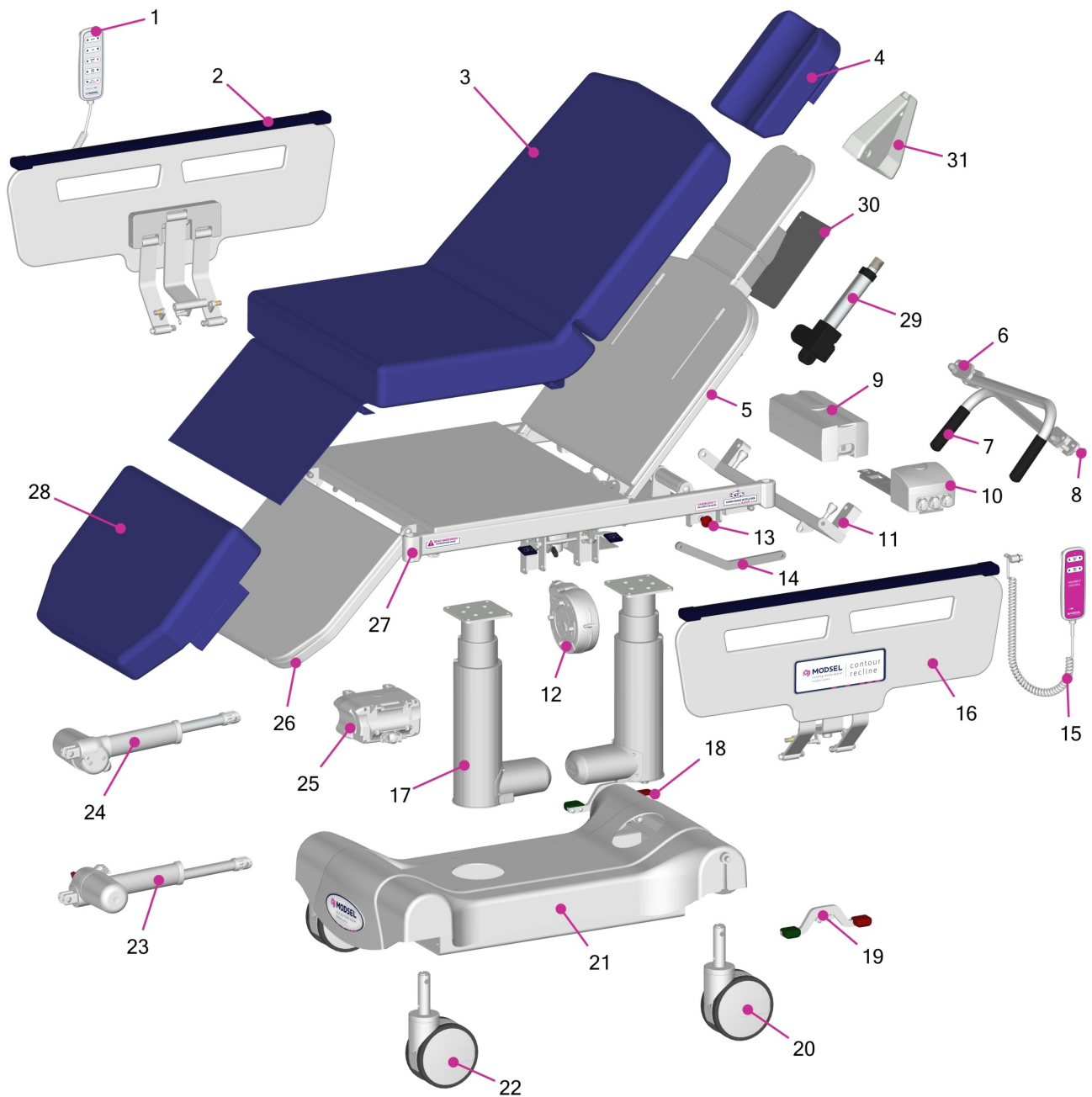

Overall Size: 650mm seat width (Standard), 750mm (Wide)

Dropside Part Identification

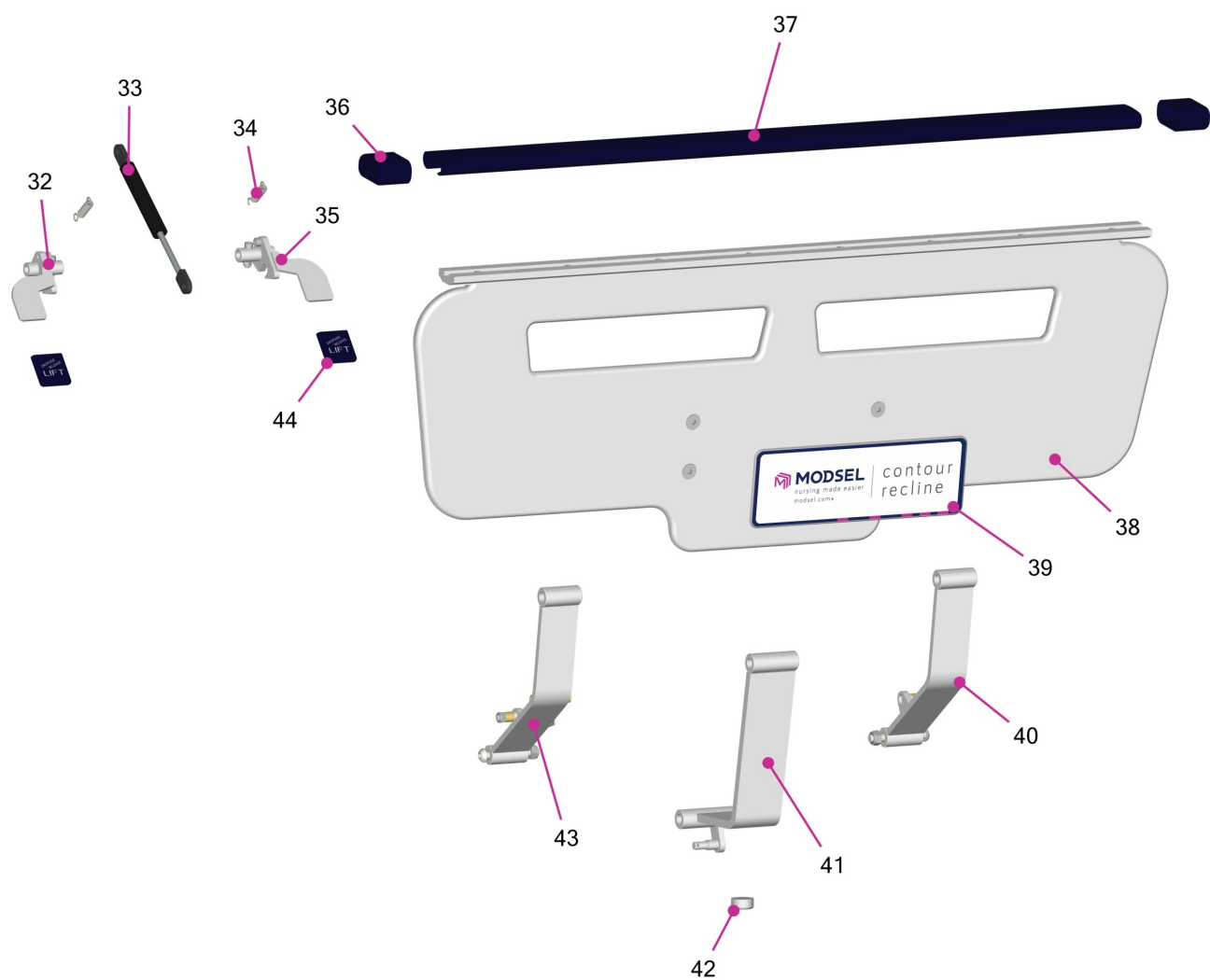

Spare Part Identification Table

Item	Code	Description
1	BIC-1805	Handset
2	MPC-SA-1008	Dropside Assembly-LH
3	MPC-J2329-Standard	E-Vertex Seat Mattress-Standard
3.1	MPC-J2329-Wide	E-Vertex Seat Mattress-Wide
4	MPT-J1306	E-Vertex Pillow Scalloped
5	MPC-WS2220-Standard	E-Vertex Backrest Frame-Standard
5.1	MPC-WS2220-Wide	E-Vertex Backrest Frame-Wide
6	MPC-SA-1011-RH	Push Handle-RH
7	MPC-SA-1011-LH	Push Handle-LH
8	FAS-1001899	Pull Knob
9	BIC-1792-3	Dewert Battery
10	BIC-1792-2	Battery Interface
11	MPC-WS1752-E-Vertex-Standard	E-Vertex Handle Mount-Standard
11.1	MPC-WS1752-E-Vertex-Wide	E-Vertex Handle Mount-Wide
12	BIC-1790	Cable Retractor
13	BIC-1804	CPR Release Cable
14	MPC-P2241	Push Handle Linkage
15	BIC-2442-E-Vertex-Headrest	Headrest Handset
16	MPC-SA-1007	Dropside Assembly-RH
17	BIC-1782	Dewert Lift Column
18	MPT-SA-2137	Steer/Brake Pedal-RH
19	MPT-SA-2138	Steer/Brake Pedal-LH
20	BIC-3233	Castor-Brake Only
21	MPC-D1652	Base Cover
22	BIC-3234	Castor-Steer/Brake

v-26042024 - Page 8

23	BIC-1800	Backrest Actuator
24	BIC-3084	E-Vertex Legrest Actuator
25	BIC-2318	Control Box
26	MPC-WS1734-Standard	Legrest Frame-Standard
26.1	MPC-WS1734-Wide	Legrest Frame-Wide
27	MPC-C1650	Corner Socket
28	MPC-J2143-Standard	Legrest Cushion-Standard
28.1	MPC-J2143-Wide	Legrest Cushion-Wide
29	BIC-2340	Headrest Actuator
30	MPT-K2320	E-Vertex Sliding Cover
31	MPT-PI1824	E-Vertex Headrest Cover
32	MPC-WS1738	Dropside Release Catch-LH
33	BIC-1001902	Dropside Damper Strut
34	BIC-1803	Catch Spring
35	MPC-WS1737	Dropside Release Catch-RH
36	MPT-E1745	PVC End Cap
37	MPC-E1655	PVC Extrusion
38	MPC-K1668	Dropside Board
39	MPC-L2187	Dropside Board Decal
40	MPC-WS1732	Dropside Arm-RH
41	MPC-WS1730	Dropside Pivot Bracket-LH
41.1	MPC-WS1731	Dropside Pivot Bracket-RH
42	BIC-1802-22mm	Bump Stop
43	MPC-WS1733	Dropside Arm-LH
44	MPC-L2139	Catch Cover

Notes

Notes
