



Contour Exami Servicing



Contour Exami Servicing

Thank you for placing your confidence in our Stretchers. They have been engineered from quality materials and hand-made with care to fulfil the requirements of the healthcare industry. Your stretcher will give years of trouble-free service if used and cared for in accordance with our directions.

As an Australian manufacturer with the longest warranty, we're committed to delivering the best value in the healthcare industry. If you have a maintenance issue with any of our products, we can help to get you back up and running again very quickly.

All of our parts are usually in stock ready for a 24 hour dispatch. Identify any [Contour Exami Stretcher](#) parts that you may need for an emergency repair or future maintenance, and contact us today for a fast, fairly priced response.

To facilitate quick and accurate identification, please supply the **SERIAL NUMBER** found on the **MODSEL** manufacturers label of the product.

Routine inspection of castors and other frame components can usually prevent common problems. After each (12) twelve months of use, the trolley must be checked in accordance with our recommended Service Checklist.

[An approved MODSEL Service Checklist can be downloaded online from this link](#)

TO ENSURE WARRANTY, PERIODIC MAINTENANCE RECORDS MUST BE RETAINED.

Disposal

- Contact Modsel or your institution expert for advice on disposal of this device.
- DO NOT repurpose this device. Modsel as the legal manufacturer of this medical device can advise if it can be reconditioned.

How To Service The Dropsides (option)

Refer to the separate [DropSide Servicing](#) guide.

How To Remove The Plastic Base Cover (option)

1. Fully raise the height of the stretcher top.
2. Lift the plastic base cover up and then twist/roll it sideways.
3. Slide the entire cover out of the base frame through the lifting legs.
4. To replace, follow reverse procedure.

How To Replace The Lifters

1. Firstly ensure the base cover is free (option) and then lay the stretcher on its side on the ground. This can be done by the following steps;
2. Stand facing the side of the stretcher – the side to stand on must be the side that you want to have lain down on the ground.
3. Pull stretcher towards you until all castors are at 90° to the length of the stretcher (facing away from you) and apply the brakes.
4. With the help of another person, firmly hold end rails at either end of the stretcher and carefully tilt it over until top makes contact with the ground.
5. Remove the retaining pins from the ends of the lifter.
6. Replace with new lifter ensuring that the new one is positioned correctly.
7. Reassemble in the reverse order to the steps above.

Spare Part Identification

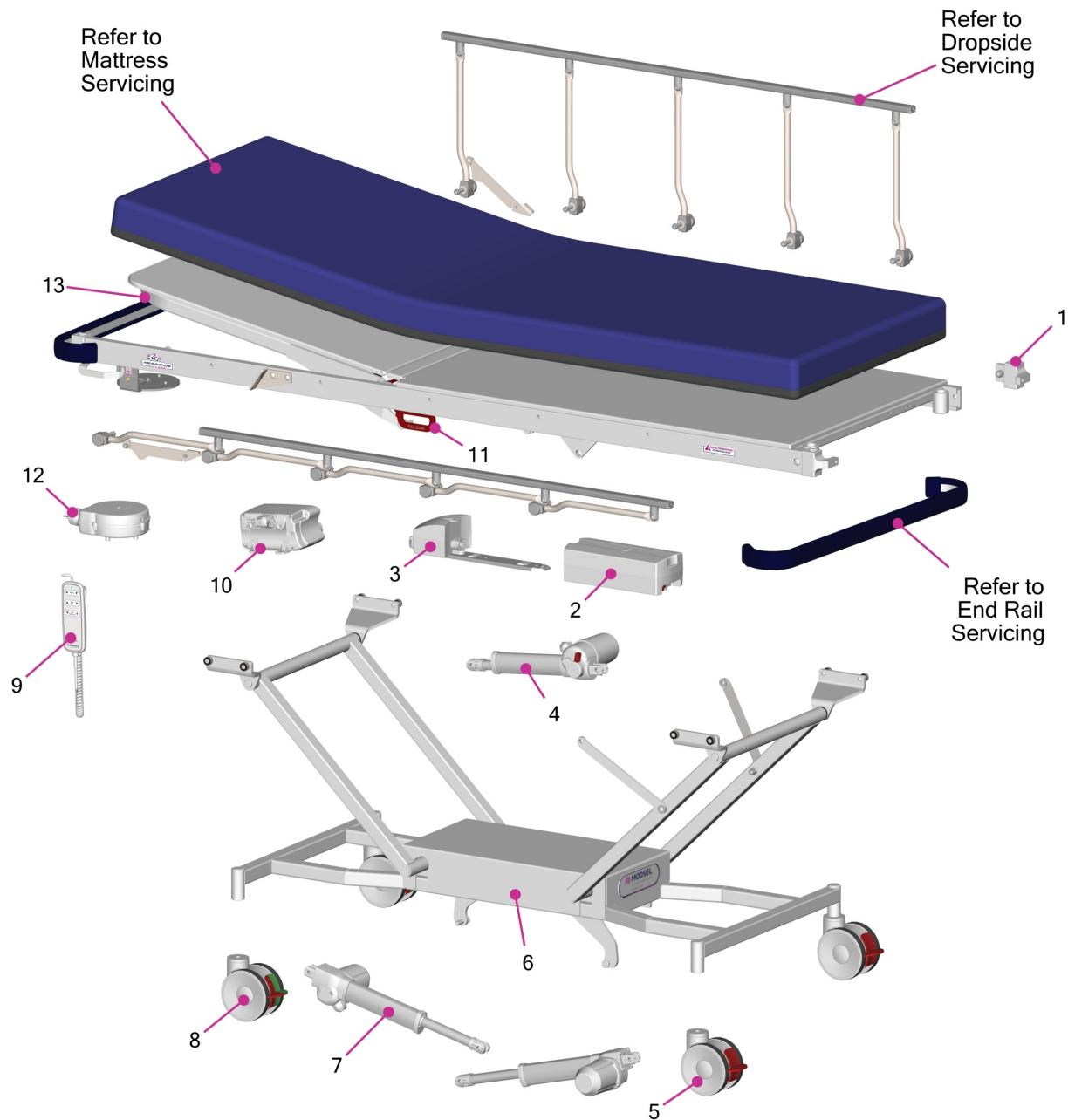

Overall Size: 2135 x 815mm overall size (965mm wide top option)

Spare Part Identification Table

Pricing in AUD, excludes GST and freight

Item	Code	Description	Price
1	MPT-C0001	Corner Casting	\$39
2	0775	Dewert Battery	\$270
3	0772	Battery Interface	\$110
4	0787	Backrest Actuator	\$260
5	9118	Castor-Brake Only	\$90
6	0023	Contour Exami Base Cover	\$240
7	P0135	Portare Hi-Lo Actuator	\$240
8	9119	Castor-Steer/Brake	\$150
9	MPT-B0522	Handset 6 Button	\$150
10	0771	Control Box	\$440
11	P0200	CPR Release Lever Assembly- Standard	\$120
11.1	P0201	CPR Release Lever Assembly- Wide	\$120
12	0768	Cable Retractor	\$60
13	P0310	Portare Backrest Frame-Standard	\$310
13.1	P0315	Portare Backrest Frame-Wide	\$330

Notes

Notes
