



Contour E-Vertex Servicing



# Contour E-Vertex Servicing

Thank you for placing your confidence in our Stretchers. They have been engineered from quality materials and hand-made with care to fulfil the requirements of the healthcare industry. Your stretcher will give years of trouble-free service if used and cared for in accordance with our directions.

As an Australian manufacturer with the longest warranty, we're committed to delivering the best value in the healthcare industry. If you have a maintenance issue with any of our products, we can help to get you back up and running again very quickly.

All of our parts are usually in stock ready for a 24 hour dispatch. Identify any [Contour E-Vertex Stretcher](#) parts that you may need for an emergency repair or future maintenance, and contact us today for a fast, fairly priced response.

To facilitate quick and accurate identification, please supply the **SERIAL NUMBER** found on the **MODSEL** manufacturers label of the product.

Routine inspection of castors and other frame components can usually prevent common problems. After each (12) twelve months of use, the trolley must be checked in accordance with our recommended Service Checklist.

[An approved MODSEL Service Checklist can be downloaded online from this link](#)

**TO ENSURE WARRANTY, PERIODIC MAINTENANCE RECORDS MUST BE RETAINED.**

## Disposal

- Contact Modsel or your institution expert for advice on disposal of this device.
- DO NOT repurpose this device. Modsel as the legal manufacturer of this medical device can advise if it can be reconditioned.

# How To Service The Dropsides

Refer to the separate [Dropside Servicing](#) guide.

## How To Remove The Plastic Base Cover

1. Remove the stretcher top assembly if you are fully replacing the base cover. If lifting the cover for base chassis access only, you may raise and tie the base cover to the top assembly (such as running a tie strap under the base cover and hooking back to the stretcher top on each side).
2. Remove plastic plugs and cover plates at each corner above the castors.
3. Lift the entire cover assembly up off the base frame.
4. To replace, follow reverse procedure.

## How To Replace The Lifters

1. Firstly ensure the base cover is free and then lay the stretcher on its side on the ground. This can be done by the following steps;
2. Stand facing the side of the stretcher – the side to stand on must be the side that you want to have lain down on the ground.
3. Pull stretcher towards you until all castors are at 90° to the length of the stretcher (facing away from you) and apply the brakes.
4. With the help of another person, firmly hold end rails at either end of the stretcher and carefully tilt it over until top makes contact with the ground.
5. Remove the bolts that are bolted through the stretcher top subframe into the top of the lifter.
6. Use a nylon hammer if required and tap the stretcher top subframe off the top of the lifter.
7. Remove the bolts from the base of the lifter.
8. Replace with new lifter ensuring that the new one is positioned correctly.
9. Using a medium strength thread locker on all bolts, reassemble in the reverse order to the steps above.

# How To Adjust The Brake/Steer System

Wear from continuous use may cause the trolley brake or steer action to not lock in properly over time. This may need to be corrected by adjusting the length of the Brake Linkage Rod.

1. Lock the right hand brake/steer pedal (from the foot end of the trolley) into the brake position. Check that the head end pedal on the same side is locking fully into the brake position at the same time. If not, the Brake Linkage Rod may need to be shortened or lengthened accordingly, to equalise the operation.
2. To adjust the Brake Linkage Rod, lift or remove the plastic base cover as per instructions above.
3. Loosen the rod end lock nut.
4. Remove the rod end retaining bolt and nut and then wind the rod end a half turn in (clockwise) to shorten or out to lengthen the Brake Linkage Rod.
5. Assemble the rod end retaining bolt loosely and test the brake/steer action. Continue to adjust the rod end until the system operates correctly.
6. Re-assemble, locking all bolts and nuts tight.

# How To Replace a Castor

1. Check the replacement castor is the correct type (ie. brake or brake/steer, Catis or Tente brand).
2. Remove or lift up the plastic base cover as per the instructions above.
3. Set the brake pedal the neutral position. Loosen the pedal lock screws at castor to be removed. Using a suitable marker pen, mark the position of the hex lug on the hex rod. Loosen the lock screw on the hex lug to allow the hex rod to slide through. Use a pin punch on the end of the hex rod, to drive clear of the castor.
4. Release the lock tab and remove the castor retaining bolts. Remove old castor. Remove any plastic bolt-hole plugs if in the castor spigot and insert the replacement castor. **DO NOT ROTATE THE CASTOR SPIGGOT, AS THIS MAY ALTER THE CASTOR SETTINGS.**
5. Align the hex rod with the hole in the castor spigot. If the hex rod will not slide through the spigot, remove and rotate entire castor 180° and re-fit. Tap the hex lug back into the original position using a soft hammer and tighten lock screw using medium strength thread locker. Replace the castor retaining bolts together with the existing or new lock tab. Tighten the castor lock screws. Bend bolt locking tabs into position against bolt heads.
6. Replace brake pedal ensuring adequate clearance both sides of the base for the cover.

# How To Replace A Headrest Actuator

1. Position the headrest upwards in both its height and tilt functions.
2. Undo the 3 retaining bolts holding the cover on the underside of the headrest.
3. Remove the headrest cover and slide out the plastic strip that covers the underside of the hinge system.
4. Remove the R-Clip and pivot pin retaining the actuator extension at the headrest end.
5. Unwind the actuator extension (anti-clockwise) until the actuator ram becomes free - slide both the extension and ram out.
6. Disconnect the power cable and remove the pin retaining the lower end of the actuator (at the bottom of the backrest)
7. Remove the actuator and replace in the reverse order.

# Spare Part Identification

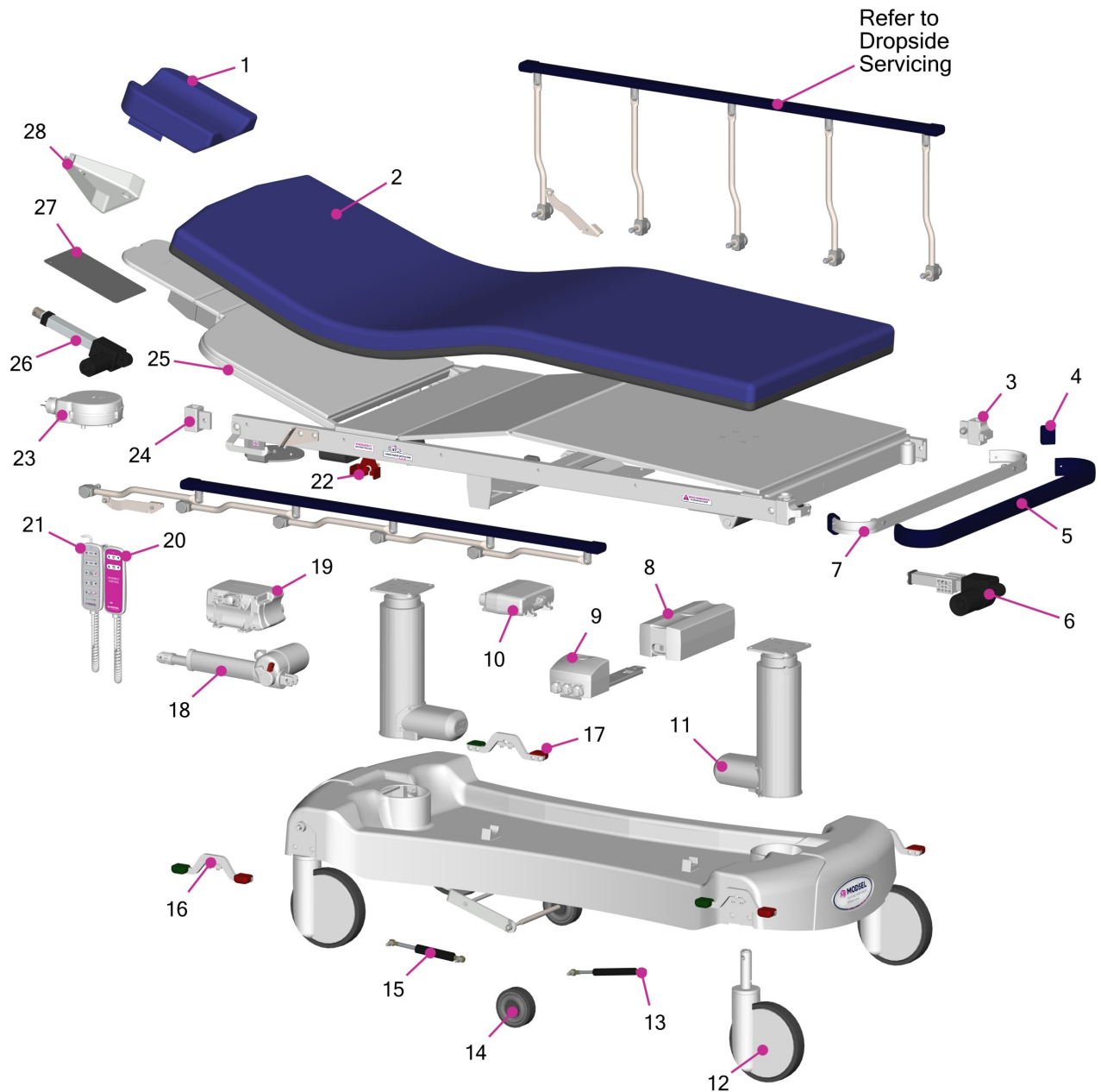

**Overall Size:** 2135 x 815mm overall size (705mm narrow or 965mm wide top options)

# Spare Part Identification Table

Item	Code	Description
1	MPT-J1306	E-Vertex Pillow Scalloped 75mm
2	MPT-J1304-Standard	75mm Premia E-Vertex Mattress - Standard
2.1	MPT-J1304-Narrow	75mm Premia E-Vertex Mattress - Narrow
2.2	MPT-J1304-Wide	75mm Premia E-Vertex Mattress - Wide
3	MPT-C2718	Corner Casting
4	MPT-E1745	PVC End Cap
5	MPT-E2696-Standard	End Rail PVC Extrusion - Standard
5.1	MPT-E2696-Narrow	End Rail PVC Extrusion - Narrow
5.2	MPT-E2696-Wide	End Rail PVC Extrusion - Wide
6	BIC-3037	Knee Bend Actuator
7	MPT-E2695-Standard	End Rail Aluminium Extrusion-Standard
7.1	MPT-E2695-Narrow	End Rail Aluminium Extrusion-Narrow
7.2	MPT-E2695-Wide	End Rail Aluminium Extrusion-Wide
8	BIC-1792-3	Dewert Battery
9	BIC-1792-2	Battery Interface
10	BIC-2277	Headrest Control Box
11	BIC-1782	Dewert Lift Column
12	BIC-2440	Castor-Brake Only
13	BIC-1001722	5th Wheel Strut-50N
14	BIC-2441	Wheel-Ezi Trak
15	BIC-1001721	5th Wheel Strut-600N
16	MPT-SA-2138	Steer/Brake Pedal-LH
17	MPT-SA-2137	Steer/Brake Pedal-RH
18	BIC-2435	Backrest Actuator
19	BIC-3121	Control Box

v-05052024 - Page 7

20	BIC-2442-E-Vertex	Headrest Handset
21	BIC-2442	Handset
22	BIC-1804	CPR Release Cable
23	BIC-1790	Cable Retractor
24	MPT-C2718-E-Vertex	Corner Casting-E-Vertex
25	MPT-WS3091-Standard	E-Vertex Backrest Frame-Standard
25.1	MPT-WS3091-Narrow	E-Vertex Backrest Frame-Narrow
25.2	MPT-WS3091-Wide	E-Vertex Backrest Frame-Wide
26	BIC-2340	Headrest Actuator
27	MPT-K2320	E-Vertex Sliding Cover
28	MPT-PI1824	E-Vertex Headrest Cover



# Notes

-----

-----

-----

-----

-----

-----

-----

-----

-----

-----

-----

-----

-----

-----

-----

# Notes

-----

-----

-----

-----

-----

-----

-----

-----

-----

-----

-----

-----

-----

-----

-----

# Notes

-----

-----

-----

-----

-----

-----

-----

-----

-----

-----

-----

-----

-----

-----

-----

